

Instructions for Use:

Zyris Operatory Fogger

ZYRIS

zyris.com

Unbox the Zyris Operatory Fogger and Verify You Have the Following Items:

Zyris Operatory Fogger

- Fogger Unit Handpiece and attached 15 inch Coiled Hose with ¼ inch Quick-disconnect
- Bottle Straw
- ¼ inch to ⅜ inch Black Quick-disconnect Barrel Adapter
- 16 ounce bottle of Zyris Disinfectant

Wall Mount Kit

- Wall mount bracket
- Screw set with Drywall Anchors
- ¼ inch Quick-disconnect Holder
- ⅜ inch Quick-disconnect Holder

Air Pressure Gauge Kit

- Air Pressure Gauge
- White ¼ inch adapter
- White ⅜ inch adapter

1

Tools Needed for Installation (Not Included):

- Phillips screwdriver
- Drill and drill bit (Only needed when drywall anchors are needed for the wall mount)

Description:

Zyris Operatory Fogger provides a convenient, easy to use, effective fogging system to disinfect the operatory after each patient. It uses the Zyris Disinfectant. It is a dedicated fogger that can be plugged into a female air quick-disconnect port found commonly in dental practices. Zyris Disinfectant is easily swapped in and out by simply unscrewing the bottle and attaching a replacement bottle. The system generates a fog that coats all surfaces uniformly and quickly. Additional bottles of Zyris Disinfectant can be purchased at www.zyris.com.

2

Female Air Quick-Disconnect (Recommended):

The Zyris Operatory Fogger is plugged into a female air quick-disconnect port which provides the 60-80 PSI air pressure required to create the fog. It comes with a ¼ inch quick-disconnect ready to simply plug in. If your port is ⅜ inches, an adapter has been supplied that you slip over the ¼ inch quick-disconnect barrel.

Note: If your chair or operatory doesn't have an air quick-disconnect port installed, you will need to work with your technician to get one installed or have them connect the ¼ inch hose directly to your air system by removing the ¼ inch quick-disconnect.

3

Testing your PSI Level:

60-80 PSI is recommended for best fogging effect with the Zyris Operatory Fogger. This is a common pressure setting in a dental operatory. To test your PSI, locate the supplied pressure gauge and the ¼ inch and ⅜ inch adapters.

1. Determine your female quick-disconnect port size. (¼ inch and ⅜ inch are standard)
2. Locate the supplied pressure gauge. If you have a ¼ inch female quick-disconnect port, screw the white ¼ inch adapter onto the gauge. The gauge with adapter will now fit into the female quick-disconnect port and you are ready to test the pressure. If your quick-disconnect is ⅜ inch, screw the white ⅜ inch adapter onto the gauge. The gauge with adapter will now fit into the female quick-disconnect and you are ready to test the pressure.
3. Place the pressure tester into the female port in your facility.
4. While connected, read the pressure measure in PSI.

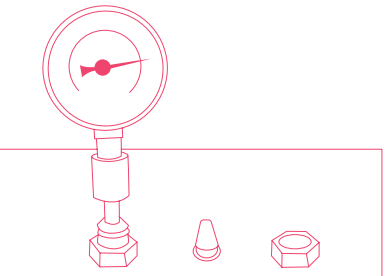

4

The optimal range for the Zyris Operatory Fogger is between 60-80 PSI. If your pressure is too high or too low, the fogger mist will be too wet or not spray evenly. If you find that your air pressure needs to be adjusted, contact your technician.

Installation Instructions:

1. Locate the Bottle Straw and firmly press fit the straw onto the Zyris Operatory Fogger.
2. Uncap the bottle of Zyris Disinfectant. Screw the full bottle over the bottle straw and into the threaded socket at the base of the Zyris Operatory Fogger.

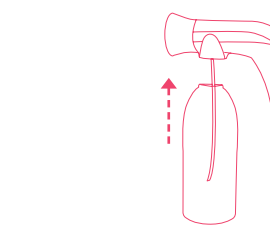
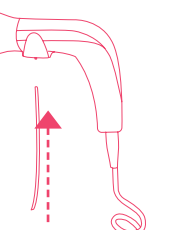

5

3. Locate the female quick-disconnect air port in your operatory and determine the dimension – ¼ inch and ⅜ inch are common sizes.

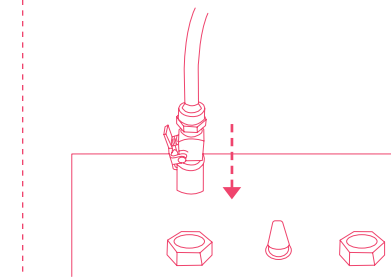

4. Plug the male quick-disconnect at the end of the hose into the female quick-disconnect air port.

Note: If you have ⅜ inch port, you will need to attach the black ⅜ inch quick-disconnect barrel adapter onto the end of the male quick-disconnect at end of the unit.

5. Your unit is now ready to begin fogging. Depress the trigger on the handpiece to begin.

6

Mounting Instructions:

When not in use, the Zyris Operator Fogger is intended to be hung on a wall or inside a cabinet with a wall bracket. It is not recommended to place the Zyris Operator Fogger on the counter. The fogger may fall over or fall off the counter due to the pull of the coiled hose.

The mount also has a quick disconnect holder for the hose to be placed into when not in use.

Note: Depending on your operatory set up and mounting options, you may choose to keep the unit plugged into your quick-disconnect if desired.

Bracket Installation:

Step 1 Choose a location and height that is comfortable to reach the handle.

Step 2 Place the Wall Mount Bracket against the wall and with a pencil, pen, or marker make indications through the 4 holes on the Wall Mount Bracket for where the holes in the wall will be. (A stud finder will be useful if available to ensure if a drywall anchor is needed for the following steps.)

Step 3 If a Drywall Anchor is not needed skip to step 5. Using a small drill bit, drill a pilot hole for each drywall anchor in each of the four locations indicated in Step 2.

Step 4 After the drilling the four pilot holes, use a screwdriver to screw the white drywall anchor into each of the holes until it is flush with the wall.

Step 5 Identify the size of the quick disconnect of your system (either ¼ inch or ⅜ inch) and choose the corresponding Wall Mount Adapter to insert into the Wall Mount Bracket.

IMPORTANT: If this step is skipped or the wrong adapter is selected, you will need to remove the Wall Mount Bracket from the wall to change to correct size.

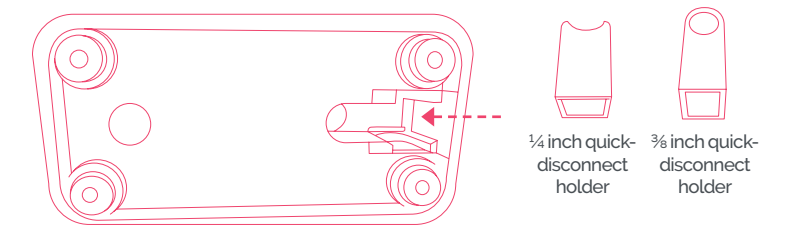

Step 6 Screw in the 4 screws provided until the Wall Mount Bracket is flush with the wall.

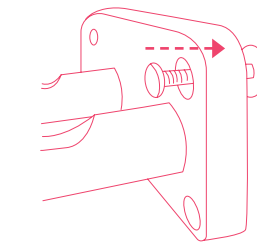

Mounting Instructions:

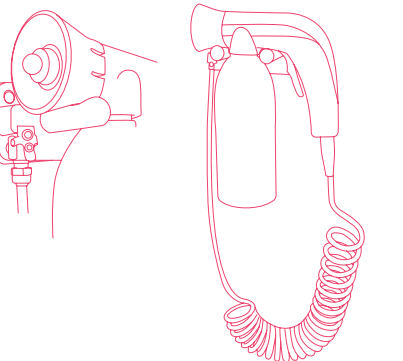

Place unit on mounting bracket and insert the quick disconnect end of hose into quick-disconnect holder when not in use.

Using the Zyris Operator Fogger:

Only use Zyris Disinfectant. This unit was designed to use Zyris Disinfectant and use of other substances may void your warranty. Follow all usage instructions from the Zyris Disinfectant Label for application and contact times.

To use the Zyris Operator Fogger, aim spray nozzle at the area intended for disinfection, pull trigger until prescribed surface wetting is achieved. (See Zyris Disinfectant Label).

After prescribed contact time, (See Zyris Disinfectant Label) you may optionally choose to use a clean cloth or towel to dry the surface or wait to allow the surface to air dry.

Storage and Disposal:

The Zyris Operator Fogger can be stored under normal office environment parameters.

The Zyris Operator Fogger is not considered a medical device and has no specific disposal requirements.

Troubleshooting:

Is your spray too wet or too fine? If so, remove the Fog Cone and make sure nozzle is finger tight.

If that does not solve the issue, you will need to test your PSI to ensure it is between 60-80 PSI. See the section titled "Testing your PSI Level".

WARNINGS

WARNING: To prevent damage to equipment, use only the Zyris Disinfectant.

WARNING: Use of other fluids may void the warranty.

WARNING: Follow all usage instructions from the Zyris Disinfectant Label.

WARNING: Do not use if box is damaged.